

high efficiency three phase asynchronous motor

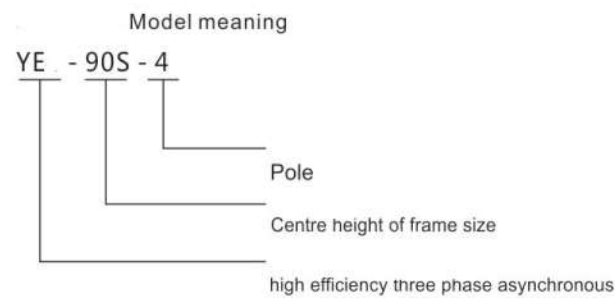

YE4 Series motor is developed with high efficiency in order to meet the requirements of the national energy conservation and emission reduction and market demand. It has many advantages such as strong load bearing, high efficiency, low noise, high torque, good starting performance, compact structure and easy maintenance. It's widely used in various fields of national economy: machine tool, pump, fan industries, compressor and etc., also in transportation, mixing, printing, agricultural machinery, food industry and so on. (Places don't have flammable and corrosive gas.)



**Structure and Installation Method**

Frame size	Structure and Installation Method
80-160	B3, B5, B6, B14, B34, B35, V1, V3, V5, V6, V15
180-280	B3, B5, B35, V1
315-450	B3, B35, V1

**Technical parameters**

- Basic characteristics
  - 80-450mm
  - 0.55-1000kW;
  - 380V50Hz
  - IP 55
  - 155 (F)
  - S1
  - IC411

- Conditions of usage
  - 15°C~+40°C
  - 1000

Working ambient temperature: -15°C~40°C  
 The altitude: not above 1000m  
 If any special please mention when placing order.

Centre height of frame size: 80-450mm  
 Power range: 0.55-1000kw  
 Rated voltage and frequency: 380V 50Hz (special should order)  
 Protection class: IP55  
 Insulation class: 155(F)  
 Duty type: S1  
 Type of cooling: IC411  
 Power 3kw and below is star-connection;  
 Power above 3kw is delta-connection.

**Technical data**

Type	kW	r/min	A	η(%)	COSΦ	Ist/In	Ist/In	I <sub>max</sub> /I <sub>n</sub>						
同步转速synchronous speed 3000r/min														
YE -80M1-2	0.75	2850	1.6	83.5	0.83	8.5	2.2	2.3						
YE -80M2-2	1.1		2.4	85.2	0.83									
YE -90S-2	1.5		3.1	86.5	0.85									
YE -90L-2	2.2	2890	4.4	88	0.86	9.0	2.0	2.3						
YE -100L-2	3		5.9	90.4	0.87									
YE -112M-2	4		7.7	90	0.88									
YE -132S1-2	5.5	2920	10.4	90.9	0.89	9.5	2.0	2.3						
YE -132S2-2	7.5		14.0	91.7										
YE -160M1-2	11		20.3	92.6										
YE -160M2-2	15	2940	27.4	93.3	0.89	9.0	1.8	2.2						
YE -160L-2	18.5		33.7	93.7										
YE -180M-2	22		40.0	94.0										
YE -200L1-2	30	2960	54.2	94.5	0.89	8.5	1.6	1.8						
YE -200L2-2	37		66.6	94.8										
YE -225M-2	45		80.9	95.0										
YE -250M-2	55	2970	98.5	95.3	0.91	8.6	0.9	1.8						
YE -280S-2	75		134	95.6										
YE -280M-2	90		160	95.8										
YE -315S-2	110	2980	196	96.0	0.91	8.7	0.8	1.8						
YE -315M-2	132		234	96.2										
YE -315L1-2	160		284	96.3										
YE -315L2-2	200	2980	354	96.5	0.92	8.1	0.6	1.8						
YE -355M-2	250		432.5	96.5										
YE -355L-2	315		545	96.5										
YE -3551-2	355	2982	621	96.5	0.90	8.6	0.9	1.8						
YE -3552-2	400		699.7											
YE -3553-2	450		787.2											
YE -4001-2	500	2982	874.7	96.5	0.91	8.7	0.8	1.8						
YE -4002-2	560		968.9											
YE -4003-2	630		1090											
YE -4501-2	710	2985	1228	96.5	0.91	8.0	0.6	1.8						
YE -4502-2	800		1384											
YE -4503-2	900		1557											
YE -4504-2	1000	2985	1711	96.5	0.92	8.1	0.6	1.8						
同步转速synchronous speed 1500r/min														
YE -80M1-4	0.55		1435						1.8	85.7	0.75	8.5	2.3	2.3
YE -80M2-4	0.75	1.8		85.7	0.74									
YE -90S-4	1.1	2.6		87.2	0.75									
YE -90L-4	1.5	1435	3.4	88.2	0.76	9.0	2.0	2.3						
YE -100L1-4	2.2		4.7	89.5	0.79									
YE -100L2-4	3		6.3	90.4	0.80									
YE -112M-4	4	1455	8.3	91.1	0.80	9.5	2.0	2.3						
YE -132S-4	5.5		11.4	91.9										
YE -132M-4	7.5		15.2	92.6					0.81					
YE -160M-4	11	1470	21.6	93.3	0.83	9.0	1.8	2.2						
YE -160L-4	15		28.9	93.9	0.84									
YE -180M-4	18.5		35.1	94.2										
YE -180L-4	22	1475	41.6	94.5	0.85	8.5	0.9	1.8						
YE -200L-4	30		56.5	94.9										
YE -225S-4	37		69.5	95.2										
YE -225M-4	45	1480	84.3	95.4	0.86	9.0	0.8	1.8						
YE -250M-4	55		101.5	95.7										
YE -280S-4	75		136.5	96.0										
YE -280M-4	90	1485	162	96.1	0.88	8.5	0.9	1.8						
YE -315S-4	110		195	96.3										
YE -315M-4	132		234	96.4										
YE -315L1-4	160	1488	280	96.6	0.89	9.0	0.8	1.8						
YE -315L2-4	200		349											
YE -355M-4	250		436											
YE -355L-4	315	1490	550	96.7	0.88	8.6	0.6	1.8						
YE -3551-4	355		634											
YE -3552-4	400		714											
YE -3553-4	450	1493	803	96.7	0.89	7.8	0.6	1.8						
YE -4001-4	500		893											
YE -4002-4	560		1000											
YE -4003-4	630	1493	1125	96.7	0.89	8.6	0.6	1.8						
YE -4501-4	710		1268											

Technical data

Type	kW	r/min	A	$\eta$ (%)	COS $\Phi$	Ist/I <sub>n</sub>	Ist/I <sub>n</sub>	I <sub>max</sub> /I <sub>n</sub>
synchronous speed 1500r/min								
YE -4502-4	800	1490	1397	96.7	0.9	7.9	0.6	1.8
YE -4503-4	900		1571					
YE -4504-4	1000		1746					
synchronous speed 1000r/min								
YE -90S-6	0.75	930	2.0	82.7	0.70	7.5	2.1	2.1
YE -90L-6	1.1	950	2.8	84.5	0.71	7.5	2.1	2.1
YE -100L-6	1.5		3.7	85.9				
YE -112M-6	2.2	960	5.4	87.4	0.71	8.0	2.0	2.1
YE -132S-6	3	970	7.2	88.6	0.71			
YE -132M1-6	4		9.4	89.5	0.72			
YE -132M2-6	5.5	975	12.8	90.5	0.72	8.5	2.0	2.1
YE -160M-6	7.5		16.4	91.3	0.76			
YE -160L-6	11	980	23.5	92.3	0.77	8.3	2.0	2.1
YE -180L-6	15		30.7	92.9	0.80			
YE -200L1-6	18.5	985	37.6	93.4	0.80	8.5	2.0	2.1
YE -200L2-6	22		44.0	93.7	0.81			
YE -225M-6	30	990	59.0	94.2	0.82	8.5	2.0	2.1
YE -250M-6	37		71.7	94.5	0.83			
YE -280S-6	45	985	86.9	94.8	0.83	8.0	1.6	2.0
YE -280M-6	55		104.6	95.1	0.84			
YE -315S-6	75	990	142	95.4	0.84	8.0	1.6	2.0
YE -315M-6	90		168	95.6	0.85			
YE -315L1-6	110	994	205	95.8	0.86	8.0	1.6	2.0
YE -315L2-6	132		243	96.0				
YE -355M1-6	160	994	294	96.2	0.82	7.9	0.9	1.8
YE -355M2-6	200		340	96.3				
YE -355L-6	250	994	458	96.5	0.83	8.0	0.8	1.8
YE -3552-6	315		604.2	96.6				
YE -3553-6	355	994	680.9	96.6	0.84	8.1	0.6	1.8
YE -4001-6	400		758					
YE -4002-6	450	994	852.7	96.6	0.84	7.4	0.6	1.8
YE -4003-6	500		947.5					
YE -4501-6	560	994	1049	96.6	0.84	7.4	0.6	1.8
YE -4502-6	630		1180					
YE -4503-6	710	994	1329	96.6	0.84	7.4	0.6	1.8
YE -4504-6	800		1498					
synchronous speed 750r/min								
YE -100L1-8	0.75	690	2.2	78.4	0.66	7.0	2	1.8
YE -100L2-8	1.1		3.1	80.8	0.67			
YE -112M-8	1.5	695	4.0	82.6	0.69	7.5	2	1.8
YE -132S-8	2.2		5.7	84.5	0.7			
YE -132M-8	3	710	7.6	85.9	0.71	7.9	2	2.0
YE -160M1-8	4	725	9.8	87.1	0.72			
YE -160M2-8	5.5		13.1	88.3	0.72	8.1	2	2.0
YE -160L-8	7.5	17.2	89.3	0.74				
YE -180L-8	11	725	25.0	90.4	0.74	8.0	2	2.0
YE -200L-8	15		33.3	91.2	0.75			
YE -225S-8	18.5	735	40.9	91.7	0.75	8.3	2	2.0
YE -225M-8	22		47.8	92.1	0.76			
YE -250M-8	30	740	63.9	92.7	0.77	7.9	2	2.0
YE -280S-8	37		77.4	93.1	0.78			
YE -280M-8	45	740	93.8	93.4	0.78	8.2	1.6	2.0
YE -315S-8	55		111.5	93.7	0.80			
YE -315M-8	75	742	151	94.2	0.81	7.7	1.6	2.0
YE -315L1-8	90		179	94.4				
YE -315L2-8	110	742	218	94.7	0.82	7.8	1.1	1.8
YE -355M1-8	132		261	94.9				
YE -355M2-8	160	742	312	95.1	0.80	7.6	0.9	1.8
YE -355L-8	200		388					
YE -3552-8	250	745	498	95.4	0.81	7.8	0.8	1.8
YE -3553-8	315		627					
YE -4001-8	355	745	707	95.4	0.81	7.8	0.8	1.8
YE -4002-8	400		796					
YE -4501-8	450	745	885	95.4	0.81	7.8	0.8	1.8
YE -4502-8	500		983					
YE -4503-8	560	745	1101	95.4	0.81	7.8	0.8	1.8
YE -4504-8	630		1239					

MOUNTING AND OVERALL DIMENSIONS

IM B3 H80-355

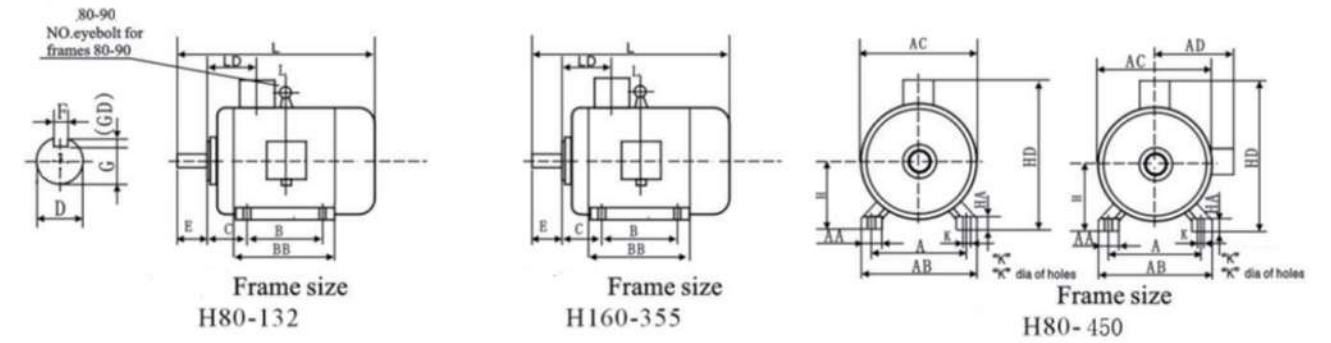

Frame	Poles	Mounting Dimension										Figure size							
		A	B	C	D	E	F	G	H	K	AA	BB	HA	AB	AC	AD	HD	L	
80M	2, 4	125	100	50	19	40	6	15.5	80	10	32	150	10	165	175	145	220	305	
90S	2, 4, 6	140	125	56	24	50	8	20	90		34	185	12	180	205	170	265	360	
90L			210	14	205	215		180	270	435									
100L	2, 4, 6, 8	160	63		28	60	24	100	12	39	223	230	255	200	310	440			
112M			190	70	80	10		33		132	55	186	18	270	310	230	365	550	
132S	4, 6, 8	216	178	89	38	80	10	33	132	12	55	224	18	270	310	230	365	550	
132M			216	89	38	80		10	33		132	55	224	18	270	310	230	365	550
160M	2, 4, 6, 8	254	210	108	42	110	12	37	160	14.5	65	304	20	320	340	260	425	730	
160L			254	108	42		12	37	160		65	304	20	320	340	260	425	730	
180M	2, 4	279	241	121	48	110	14	42.5	180	14.5	70	311	22	355	390	285	460	770	
180L	4, 6, 8		279	121	48		14	42.5	180		70	349	22	355	390	285	460	800	
200L	2, 4, 6, 8	318	305	133	55	110	16	49	200	18.5	74	379	26	395	445	320	520	860	
225S	4, 8		286	60	140		18	53	225		78	368	28	435	495	350	575	830	
225M	2	356	311	149	60	110	16	49	225	18.5	78	393	28	435	495	350	575	830	
225M	4, 6, 8		311	149	60		16	49	225		78	393	28	435	495	350	575	830	
250M	2	406	349	168	60	110	18	53	250	24	80	445	30	490	550	390	635	990	
250M	4, 6, 8		349	168	60		18	53	250		80	445	30	490	550	390	635	990	
280S	2	457	368	190	65	140	18	58	280	24	90	485	35	550	630	435	705	990	
280S	4, 6, 8		368	190	65		18	58	280		90	485	35	550	630	435	705	990	
280M	2	419	419	190	65	140	18	58	280	24	90	536	35	550	630	435	705	1040	
280M	4, 6, 8		419	190	65		18	58	280		90	536	35	550	630	435	705	1040	
315S	2	406	406	216	65	170	22	71	315	28	120	570	45	635	645	530	845	1180	
315S	4, 6, 8		406	216	65		170	22	71		315	120	570	45	635	645	530	845	1180
315M	2	508	457	216	65	170	22	71	315	28	120	610	45	635	645	530	845	1210	
315M	4, 6, 8		457	216	65		170	22	71		315	120	610	45	635	645	530	845	1210
315L	2	508	457	216	65	170	22	71	315	28	120	680	45	635	645	530	845	1320	
315L	4, 6, 8		457	216	65		170	22	71		315	120	680	45	635	645	530	845	1320
355M	2	610	560	254	75	140	20	67.5	355	35	130	690	52	730	710	655	1010	1500	
355M	4, 6, 8		560	254	75		140	20	67.5		355	130	690	52	730	710	655	1010	1500
355L	2	630	630	224	75	170	25	86	355	35	130	750	52	760	770	760	1130	1530	
355L	4, 6, 8		630	224	75		170	25	86		355	130	750	52	760	770	760	1130	1530
3551	2	630	800	224	80	210	22	71	355	35	130	950	52	760	770	760	1130	1870	
3551	4, 6, 8		800	224	80		210	22	71		355	130	950	52	760	770	760	1130	1870
3552	2	630	800	224	80	210	22	71	355	35	130	950	52	760	770	760	1130	1920	
3552	4, 6, 8		800	224	80		210	22	71		355	130	950	52	760	770	760	1130	1920
400	2	710	900	250	85	170	22	76	400	42	120	1090	45	840	860	900	1260	1910	
400	4, 6, 8		900	250	85		170	22	76		400	120	1090	45	840	860	900	1260	1910
450	2	800	1000	250	95	210	25	86	450	42	190	1295	52	990	960	940	1380	2070	

MOUNTING AND OVERALL DIMENSIONS

IM B35 H80-450

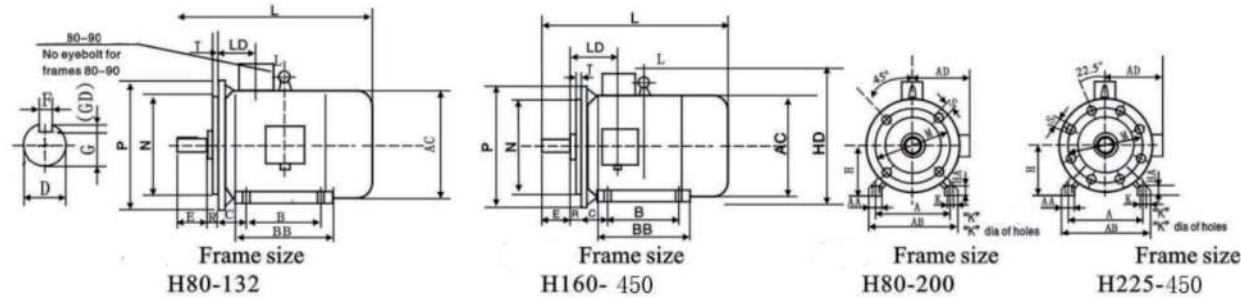

Frame	Poles	Mounting Dimension												Figure size										
		A	B	C	D	E	F	G	H	K	M	N	P	R	n-S	T	AA	BB	HA	AB	AC	AD	HD	L
80M	2, 4	125	100	50	19	40	6	15.5	80							32	150	10	165	175	145	220	305	
90S	2, 4, 6	140	125	56	24	50		20	90	10	165	130	200		4-φ12	3.5	34	185	12	180	205	170	265	395
90L	2, 4, 6, 8	160	140	63	28	60		24	100							39	223	14	205	215	180	270	435	
100L	2, 4, 6, 8	190	140	70					112	12	215	180	250			45	230		230	255	200	310	475	
112M	2, 4, 6, 8	216	178	89	38	80	10	33	132		265	230	300			55	186	18	270	310	230	365	535	
132S	4, 6, 8	254	210	108	42			12	37	160						65	304	20	320	340	260	425	730	
132M	4, 6, 8	254	210	108	42			12	37	160						65	304	20	320	340	260	425	730	
160M	2, 4, 6, 8	279	241	121	48	110		14	42.5	180	14.5	300	250	350		70	311	22	355	390	252	460	805	
160L	2, 4, 6, 8	279	241	121	48	110		14	42.5	180	14.5	300	250	350		70	311	22	355	390	252	460	805	
180M	2, 4	318	305	133	55		16	49	200		350	300	400			74	379	26	395	445	320	520	890	
180L	4, 6, 8	318	305	133	55		16	49	200		350	300	400			74	379	26	395	445	320	520	890	
200L	2, 4, 6, 8	356	286	149	55	110	16	49	225	18.5	400	350	450			78	368		435	495	350	575	865	
225S	4, 8	356	286	149	55	110	16	49	225	18.5	400	350	450			78	368		435	495	350	575	865	
225M	2	311	60					53								80	393	28	445	550	390	635	895	
225L	4, 6, 8	311	60					53								80	393	28	445	550	390	635	895	
250M	2	406	349	168			18		250							80	445	30	490	550	390	635	995	
250L	4, 6, 8	406	349	168			18		250							80	445	30	490	550	390	635	995	
280S	2	368	65				58									90	485		550	630	435	705	1030	
280M	4, 6, 8	457	190	75	140		20	67.5	280	24	500	450	550			90	485	35	550	630	435	705	1030	
280L	2	419	65				18	58								90	536		550	630	435	705	1080	
315S	2	406	65				18	58								120	570		635	645	530	845	1180	
315M	4, 6, 8	508	457	216	65	140	18	58	315		600	550	660			120	610	45	635	645	530	845	1290	
315L	2	508	65				20	67.5								120	610	45	635	645	530	845	1320	
355M	2	560	75	140	20	67.5										130	690		730	710	655	1010	1500	
355L	4, 6, 8	610	254	75	140	20	67.5		355		740	680	800			130	750	52	760	900	760	1130	1530	
3551	2	630	80				22	71								130	750	52	760	900	760	1130	1530	
3552	4, 6, 8	630	800	110	210	28	100		355		840	780	900			130	750	52	760	900	760	1130	1530	
3553	2	630	800	110	210	28	100		355		840	780	900			130	750	52	760	900	760	1130	1530	
400	2	710	900	85	170	22	76		400		940	880	1000			190	1090	45	840	1000	900	1255	1910	
400	4, 6, 8	710	900	85	170	22	76		400		940	880	1000			190	1090	45	840	1000	900	1255	1910	
450	2	800	1000	95	170	25	86		450	42	1080	1000	1150			190	1295	52	990	1150	940	1380	1975	
450	4, 6, 8	800	1000	95	170	25	86		450	42	1080	1000	1150			190	1295	52	990	1150	940	1380	1975	
450	2	800	1000	130	210	32	119		450	42	1080	1000	1150			190	1295	52	990	1150	940	1380	2070	
450	4, 6, 8	800	1000	130	210	32	119		450	42	1080	1000	1150			190	1295	52	990	1150	940	1380	2070	

MOUNTING AND OVERALL DIMENSIONS

IM B5 H80-280

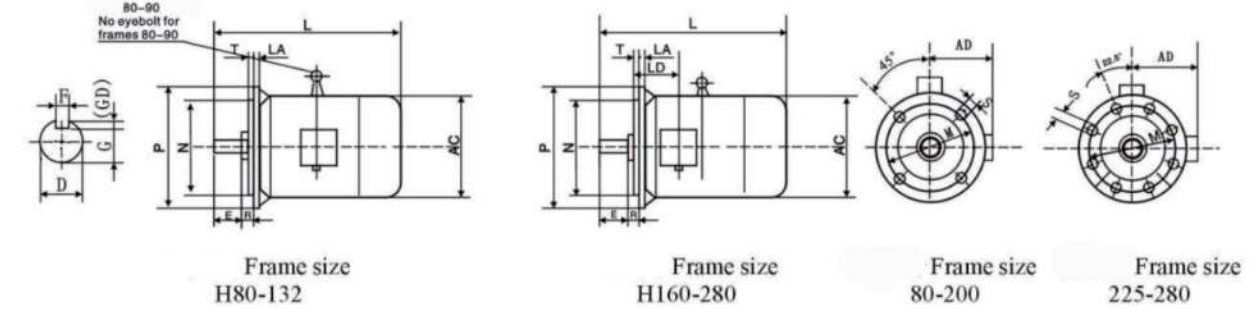

Frame	Poles	Mounting Dimension										Figure size								
		D	E	F	G	M	N	P	R	n-S	T	AC	AD	HD	L					
80M	2, 4	19	40	6	15.5											175	145	-	-	305
90S	2, 4, 6	24	50		20	165	130	200			4-φ12	3.5			205	170	-	-	395	
90L	2, 4, 6, 8			8																425
100L	2, 4, 6, 8	28	60		24	215	180	250			4-φ14.5	4			255	200	275	275	475	
112M	2, 4, 6, 8																			535
132S	4, 6, 8	38	80	10	33	265	230	300												550
132M	4, 6, 8																			550
160M	2, 4, 6, 8	42		12	37	300	250	350			4-φ18.5	4			340	260	390	390	730	
160L	2, 4, 6, 8																			760
180M	2, 4		110																	805
180L	4, 6, 8	48		14	42.5															835
200L	2, 4, 6, 8	55		16	49	350	300	400												890
225S	4, 8	60	140	18	53															865
225M	2	55	110	16	49	400	350	450												895
225L	4, 6, 8				53															895
250M	2	60																		995
250L	4, 6, 8																			995
280S	2		140																	1030
280M	4, 6, 8	75		20	67.5	500	450	550												1030
280L	2	65		18	58															1080
280M	4, 6, 8	75		20	67.5															1080

MOUNTING AND OVERALL DIMENSIONS

IM B34 H80-112

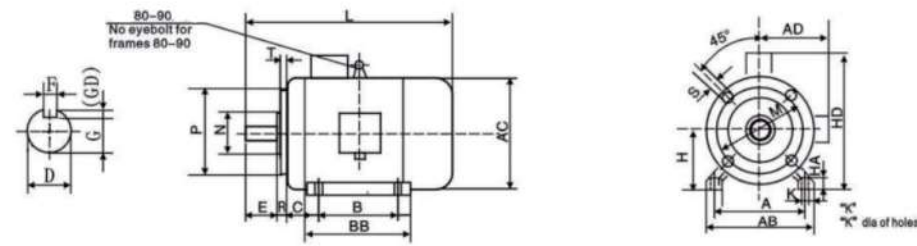

Frame	Poles	Mounting Dimension											Figure size								
		A	B	C	D	E	F	G	H	K	M	N	P	R	S	T	AB	AC	AD	HD	L
80M	2, 4	125	100	50	19	40	6	15.5	80		100	80	120	0	4-M6	3	165	175	145	220	305
90S	2, 4, 6	140	125	56	24	50	8	20	90	10	115	95	140		4-M8	3.5	180	205	170	265	360
90L		190	125	63	28	60															
100L	2, 4, 6, 8	160	140	63	28	60	8	24	100	12	130	110	160		4-M8	3.5	205	215	180	270	435
112M		190	140	70	28	60								24							

MOUNTING AND OVERALL DIMENSIONS

IM B14 H80-112

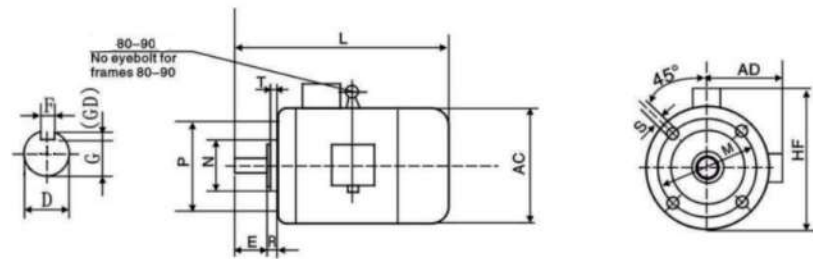

Frame	Poles	Mounting Dimension										Figure size			
		D	E	F	G	M	N	P	R	S	T	AC	AD	HF	L
80M	2, 4, 6	19	40	6	15.5	100	80	120	0	4-M6	3	175	145	-	305
90S	2, 4, 6, 8	24	50	8	20	115	95	140		4-M8	3.5	205	170	-	360
90L		190	24												
100L	2, 4, 6, 8	28	60	8	24	130	110	160		4-M8	3.5	215	180	245	435
112M		190	28						60						

MOUNTING AND OVERALL DIMENSIONS

IM V1 H180-355

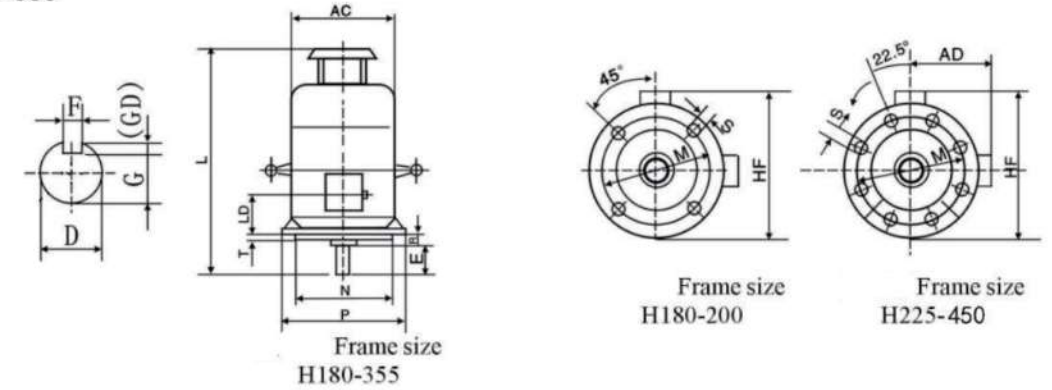

Frame	Poles	Mounting Dimension										Figure size						
		D	E	F	G	M	N	P	R	n-S	T	AC	AD	HF	L			
180M	2, 4	48	110	14	42.5	300	250	350	0	4-φ18.5	5	390	285	505	825			
180L	2, 4, 6, 8			16	49	350	300	400				445	320	565	845			
200L	2, 4, 6, 8	55	16	49	350	300	400	445				320	565	940				
225S	4, 8	60	140	18	53	400	350	450				495	350	625	945			
225M	2	55	110	16	49	500	450	550	0	8-φ18.5	5	630	435	745	1155			
250M	4, 6, 8	60	18	53	550											390	670	1095
280S	2	65	140	20	67.5	500	450	550				0	8-φ18.5	5	630	435	745	1155
280M	4, 6, 8	75		18	58													
315S	2	65	170	18	58	600	550	650	0	8-φ24	6				645	530	900	1280
315M	4, 6, 8	85		22	71													
315L	2	65	140	18	58	740	680	800				0	8-φ24	6	710	655	1010	1310
355M	4, 6, 8	100	25	86	710													
355L	2	75	140	20	67.5	740	680	800	0	8-φ24	6				710	655	1010	1640
355S	4, 6, 8	100	25	86	1640													
3552	2	80	170	22	71	840	780	900				0	8-φ28	6	900	760	1220	1920
3553	4, 6, 8	110	210	28	100													
400	2	85	170	22	76	940	880	1000	0	8-φ28	6				1000	900	1255	1960
450	4, 6, 8	120	210	32	109													
450	2	95	170	25	86	1080	1000	1150				0	8-φ28	6	1150	940	1500	2120
	450	4, 6, 8	130	210	32													